

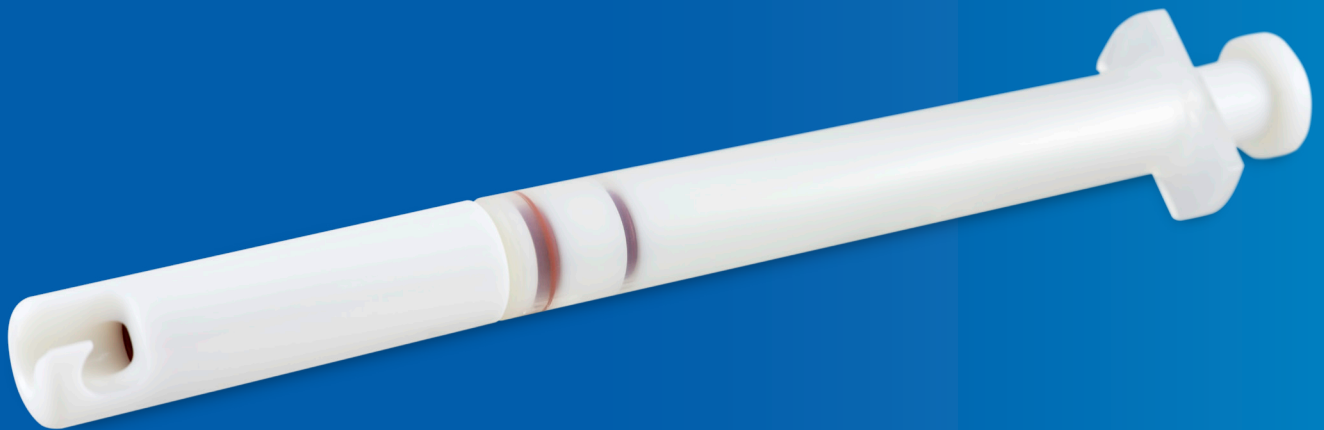

GLASS EXPANSION

Quality By Design

Using the Eluo to Clean Your Nebulizer



P/N 70-ELUO

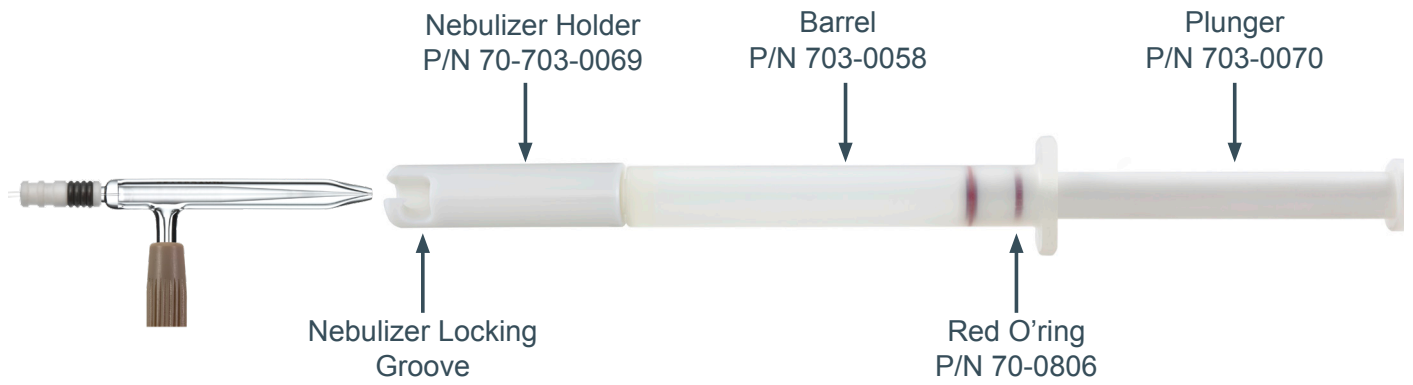

P/N 70-ELUO-OPD

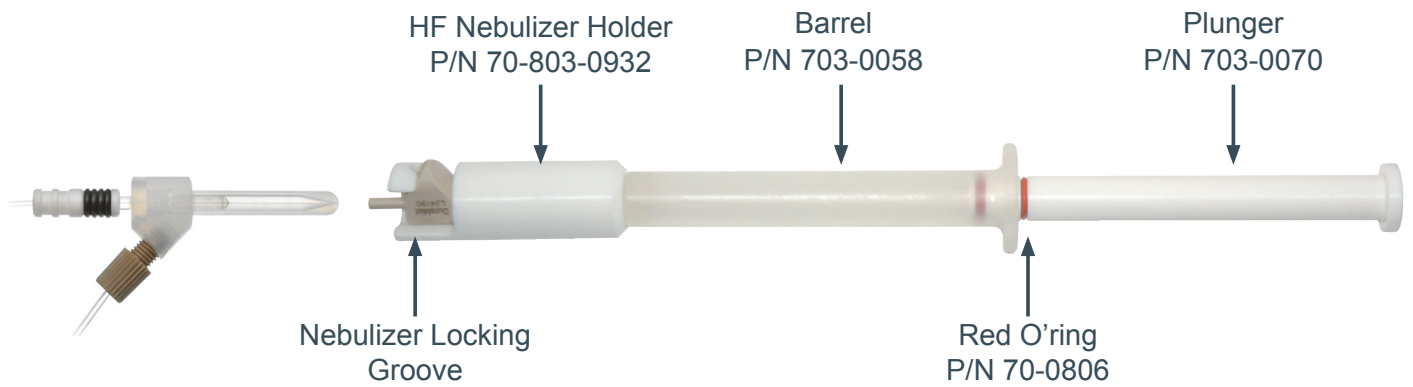

P/N 70-ELUO-OP

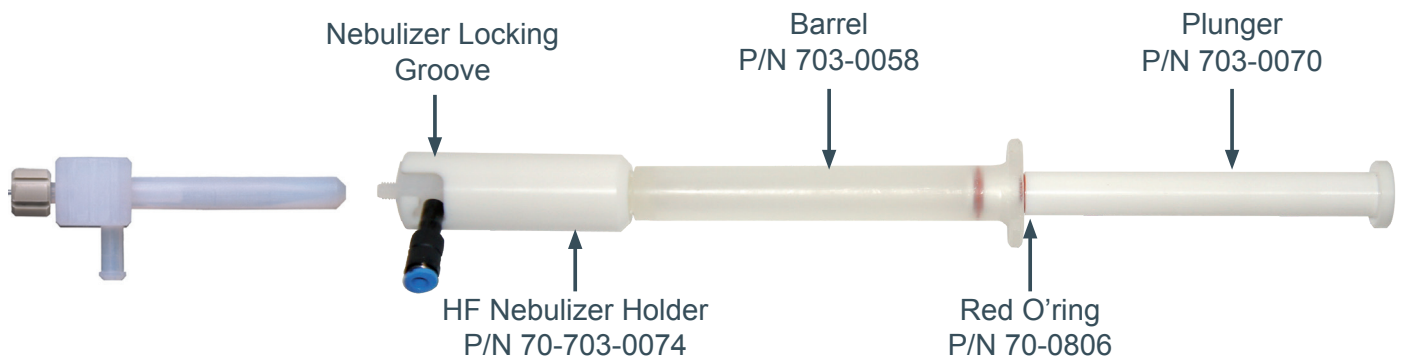

Eluo Nebulizer Cleaner Instructions

1. Remove the Nebulizer Holder from the Barrel by turning it in an anti-clockwise direction.
2. To fill the Barrel with cleaning solution, place the front of the Barrel into a container of cleaning solution. Draw the Plunger back until the first Red O'ring is visible on the Plunger shaft.
3. Re-attach the Nebulizer Holder to the Barrel by turning it in a clockwise direction until tight.
4. Insert the Nebulizer, tip first, into the Nebulizer Holder until the side arm lines up with the Nebulizer Locking Groove. Push across to lock into position, making sure the Nebulizer side arm is secure.
5. Pointing the Nebulizer over a waste vessel, press the Plunger down in a quick and constant motion until it reaches the bottom of the Barrel. Cleaning solution should be seen coming out from the end of the Nebulizer and the Nebulizer side arm.
6. If there is a particle in the sample capillary that is difficult to remove, you can increase the cleaning solution pressure and flow to the sample channel by blocking the gas side arm with a finger. Similarly, if there is a particle in the gas channel that is difficult to remove, you can increase the pressure and flow by blocking the sample inlet arm with a finger.
7. Gently shake the Eluo to remove excess cleaning solution from the Nebulizer.
8. Remove the Nebulizer from the Nebulizer Holder. Shake off any excess cleaning solution from the Eluo.
9. Replace the Nebulizer in the Nebulizer Holder making sure it is secure in the Nebulizer Locking Groove. Rapidly pull and push the Plunger backwards and forwards three or four times to help remove excess cleaning solution from the Nebulizer.
10. Remove the Nebulizer from the Nebulizer Holder. Insert the Nebulizer with the Argon gas line connected, into your Spray Chamber. Apply Argon pressure to the Nebulizer and allow it to run for 3 minutes before using it for your analysis.
11. Your Nebulizer should now be clean, dry and ready for use.

Important Note: Do not use acids with the Eluo. Always use safety gloves and glasses when using the Eluo. Always point the Eluo towards a waste vessel when depressing the plunger.

For more information please visit www.geicp.com or contact one of our offices below.

Asia Pacific

6 Central Boulevard, Port Melbourne, VIC
3207, Australia

Telephone: +61 3 9320 1111

Email: enquiries@geicp.com

Americas

31 Jonathan Bourne Drive, Unit 7 Pocasset,
MA 02559, USA

Telephone: 508 563 1800

Email: geusa@geicp.com

Europe

Friedenbachstrasse 9, 35781 Weilburg,
Germany

Telephone: +49 6471 3778517

Email: gegmbh@geicp.com